

# ACTIVHEAL® HYDROGEL APPLICATION GUIDE

DONATES MOISTURE  
PROVIDES A MOIST WOUND ENVIRONMENT  
ENCOURAGES AND FACILITATES AUTOLYSIS  
REMOVES DEVITALISED TISSUE

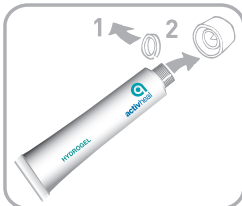

1. To open the ActivHeal® Hydrogel tube, unscrew the white lid and discard the white ring by dropping the ring from the tube, ensuring it is away from the patient and their wound.



2. Pierce the foil of the tube by screwing the white lid back onto the tube until the foil is completely pierced.

3. Cleanse the wound if necessary in accordance with standard wound cleansing protocols.

4. Apply the Hydrogel to the wound to a depth of 5mm.



5. ActivHeal® Hydrogel is extremely viscose and cohesive which ensures easy application. Ensure that the gel does not cover healthy skin.

6. ActivHeal® Hydrogel should be secured with an appropriate occlusive or semi occlusive secondary dressing.

## DRESSING CHANGES

The dressing should be changed every 2-3 days or as indicated by the clinical condition of the wound.

***N.B. Please note that ActivHeal® Hydrogel is for single use only and must be discarded after application.***